



TRANSFORMER BOBBIN  
INDUSTRIAL CO.,LTD.

Tel : 86-769-88789999 Fax : 86-769-88789989  
http:// tbi-tw.com e-mail : tb6688@ms46.hinet.net

REVISIONS

REV	SYM	DRAFTER	CHECKER	DATE
1		X.X.YUAN	G.F.YANG	11/26/13
2				
3				

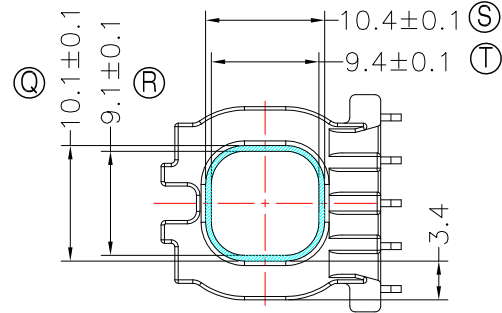
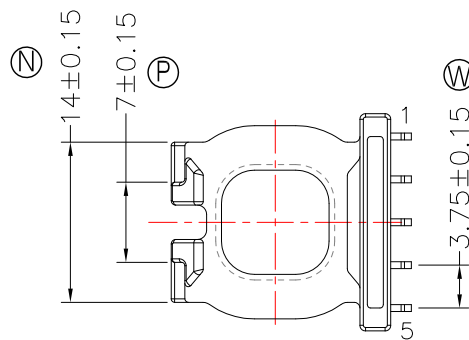
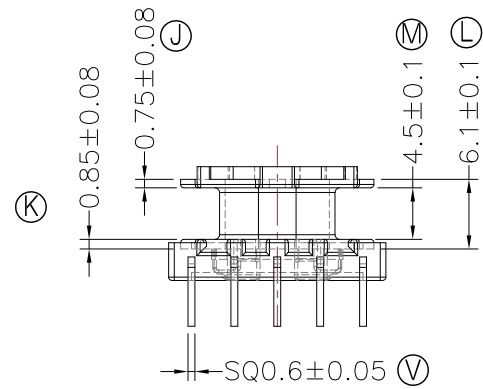
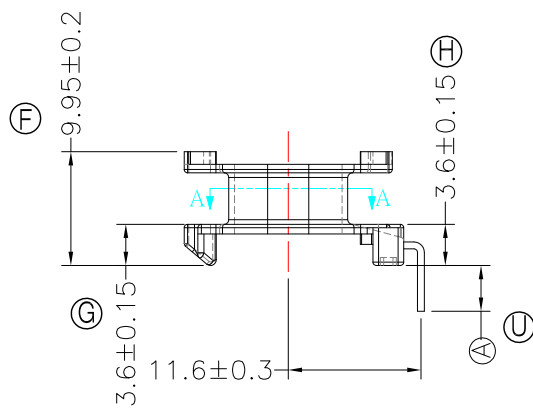
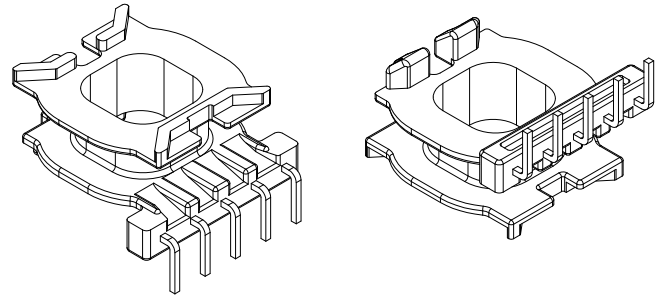
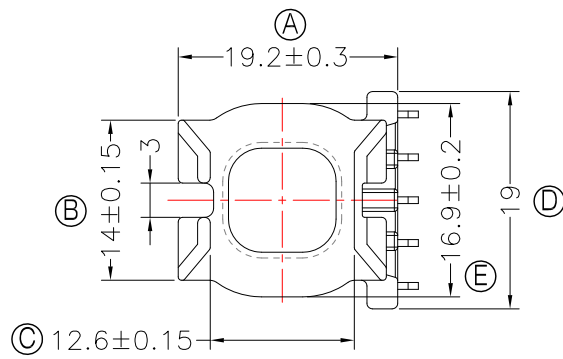

SECTION A-A

NOTE:

WINDING SPACE: 4.5mm\*3.4mm=15.3mm<sup>2</sup>

DWG NO.	ATQ22-11.8-5P-TL-1A-11				
PART NO.	MATERIAL (BOBBIN)	MATERIAL (TERMINAL)	TERMINAL (PLATING)	PIN ALLOCATION	NOTE
TBI-238-43111.1106	PM-9630	CP WIRE	Sn	ALL PIN (A)=4.0±0.2	S.C
TBI-238-43111.1116	PM-9630	CP WIRE	Sn	ALL PIN (A)=5.0±0.2	H
TBI-238-43111.1126	PM-9630	CP WIRE	Sn	CUT PIN#3 (A)=4.0±0.2	
TBI-238-43111.1136	PM-9630	CP WIRE	Sn	ALL PIN (A)=3.8±0.2	
TBI-238-43111.1146	PM-9630	CP WIRE	Sn	ALL PIN (A)=3.0±0.2	
	TOLERANCE: 0<L<=4:±0.1 4<L<=16:±0.2 16<L<=63:±0.3			UNIT : m / m	SCALE 1 : 1

Finish: 1. PB wire Immersion Sn on terminal : Thickness:Sn plating,100,5 μ m (200 μ inches) min,Base nickel 0.625 μ m (25 μ inches) min.  
2. CP wire Immersion Sn on terminal : Thickness:Sn plating,100,5 μ m (200 μ inches) min.  
3. Coplanarity deviation: 0.10 mm (0.004 inches) max.

REV 1