



TRANSFORMER BOBBIN
INDUSTRIAL CO.,LTD.

Tel : 86-769-88789999 Fax : 86-769-88789989
http:// tbi-tw.com e-mail : tb6688@ms46.hinet.net

REVISIONS

| REV | SYM | DRAFTER | CHECKER | DATE |
|-----|-----|---------|----------|----------|
| 1 | | X.H.GU | G.F.YANG | 05/15/19 |
| 2 | | | | |
| 3 | | | | |

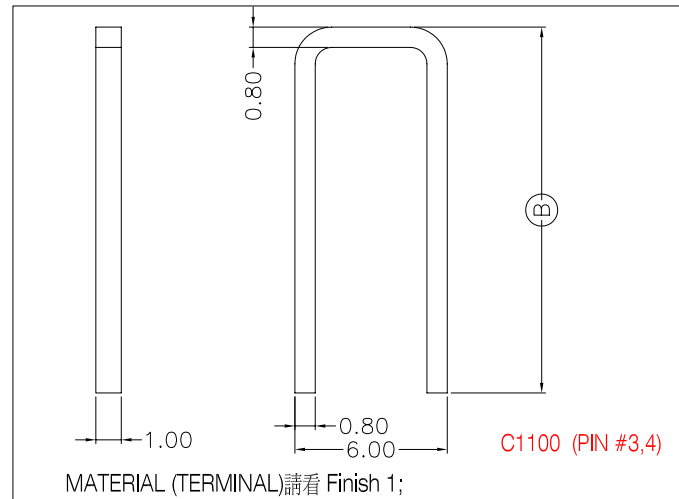
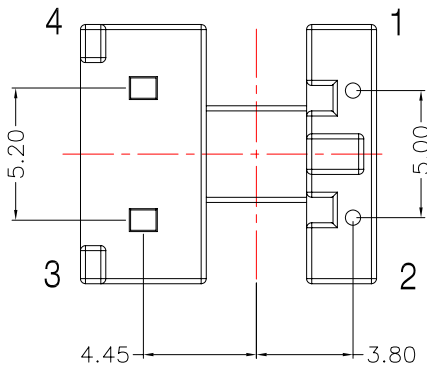
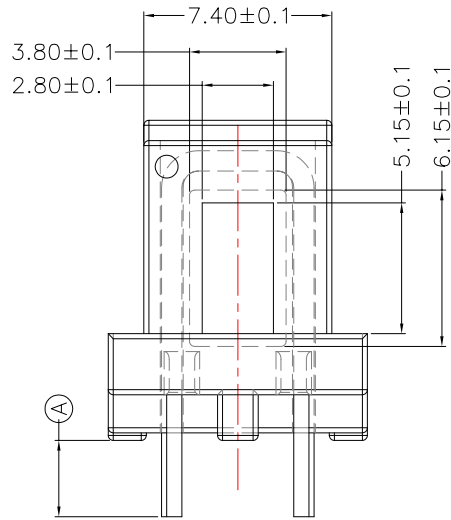
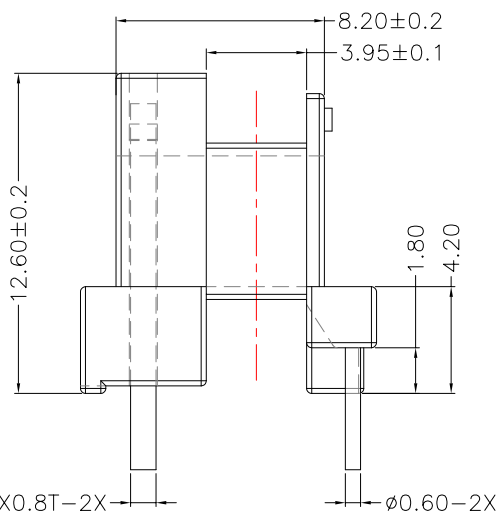
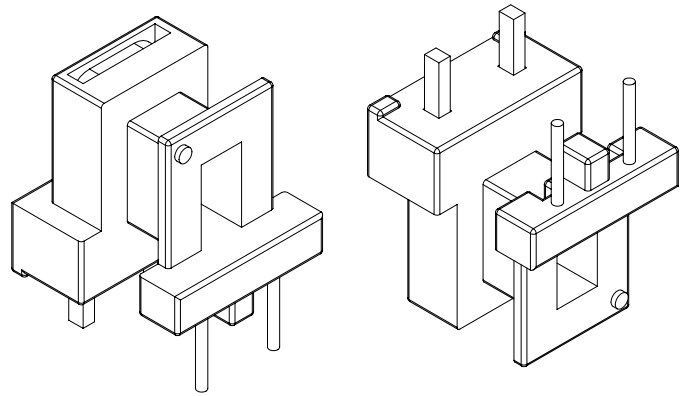
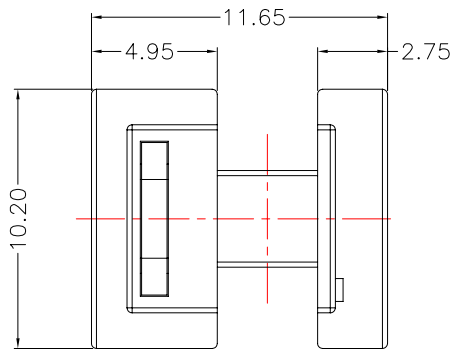

DWG NO. EE10-11-4P-TH-5.0-G-11

| PART NO. | MATERIAL (BOBBIN) | MATERIAL (TERMINAL) | TERMINAL (PLATING) | PIN ALLOCATION | NOTE |
|--------------------|-------------------|--|--------------------|----------------------------------|------|
| TBI-201-14071.1106 | PM-9630 | CP WIRE (PIN #1,2) C1100 (PIN #3,4) | Sn | ALL PIN (A)=3.2±0.2 (B)=14.6±0.2 | H |
| | | | | | |
| | | | | | |
| | | | | | |

TOLERANCE: 0<L<4:±0.1 4<L<16:±0.2 16<L<63:±0.3 UNIT : m / m SCALE 1 : 1

Finish: 1. PB wire Immersion Sn on terminal : Thickness:Sn plating,100%,5 μm (200 μ inches) min,Base nickel 0.625 μm (25 μ inches) min.

2. CP wire Immersion Sn on terminal : Thickness:Sn plating,100%,5 μm (200 μ inches) min.

3. Coplanarity deviation: 0.10 mm (0.004 inches) max.

REV 1