



**TRANSFORMER BOBBIN  
INDUSTRIAL CO.,LTD.**

Tel : 86-769-88789999 Fax : 86-769-88789989  
http:// tbi-tw.com e-mail : tb6688@ms46.hinet.net

REVISIONS

REV	SYM	DRAFTER	CHECKER	DATE
3		G.F.YANG	W.H.HSU	05/15/09
4		G.F.YANG	W.H.HSU	07/27/10
5		F.LU	G.F.YANG	12/24/10

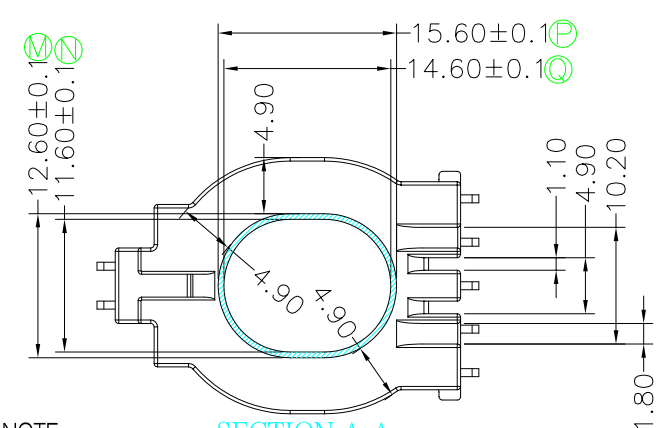
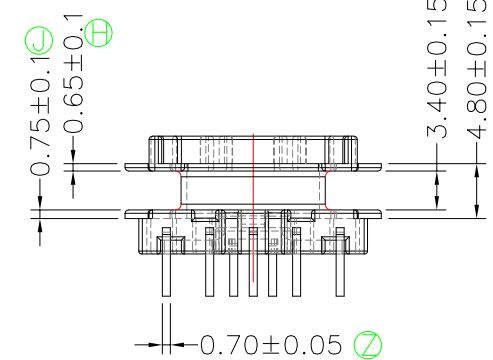
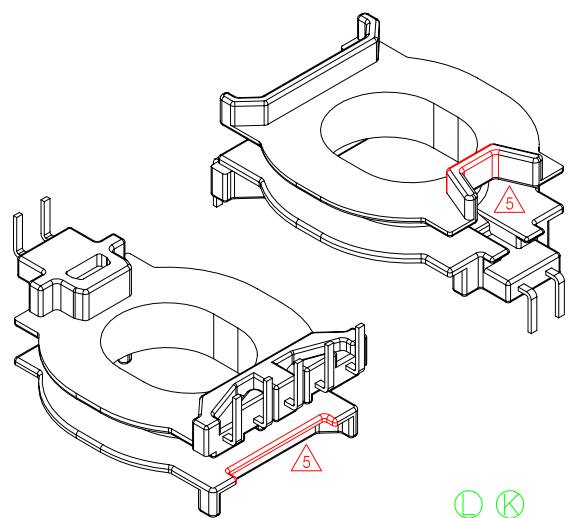
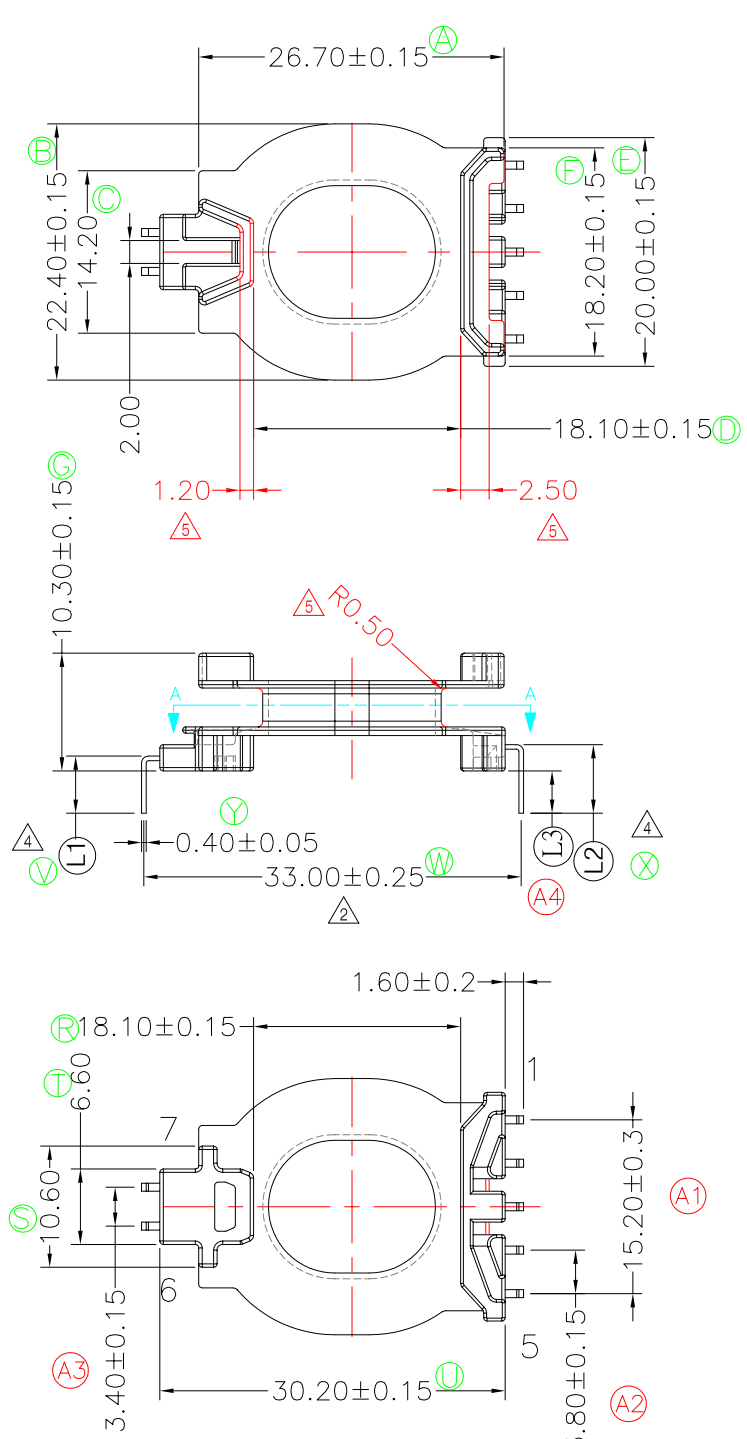

NOTE:  
SECTION A-A  
Winding Space=4.9\*3.4=16.66mm<sup>2</sup>  
任意一點強度須1.5kg MIN

DWG NO.	ATQ27-11-7P-THT-0H-11				
PART NO.	MATERIAL (BOBBIN)	MATERIAL (TERMINAL)	TERMINAL (PLATING)	PIN ALLOCATION	NOTE
TBI-238-03081.1106	PM-9630	CP WIRE	Sn	ALL PIN(L1)=5.0±0.3 (L2)=6.0±0.3(L3)=3.7±0.3	S
TBI-238-03081.1116	PM-9630	CP WIRE	Sn	ALL PIN(L1)=5.5±0.3 (L2)=6.5±0.3(L3)=4.2±0.3	H
TBI-238-03081.1126	PM-9630	CP WIRE	Sn	NO PIN#2,3,4(L1)=5.5±0.3 (L2)=6.5±0.3(L3)=4.2±0.3	
TBI-238-03081.1136	PM-9630	CP WIRE	Sn	NO PIN#3,4 (L1)=5.5±0.3 (L2)=6.5±0.3(L3)=4.2±0.3	
TBI-238-03081.1146	PM-9630	CP WIRE	Sn	NO PIN#2,3,4 (L1)=5.0±0.3 (L2)=6.0±0.3(L3)=3.7±0.3	

		TOLERANCE: .XX±0.2 .XXX±0.1	UNIT : m / m	SCALE 1 : 1
Finish: 1. PB wire Immersion Sn on terminal : Thickness:Sn plating,100,5 μm (200 μ inches) min,Base nickel 0.625 μm (25 μ inches) min. 2. CP wire Immersion Sn on terminal : Thickness:Sn plating,100,5 μm (200 μ inches) min. 3. Coplanarity deviation: 0.10 mm (0.004 inches) max.				REV 5

**A-CORE**  
ELECTRICAL CO.

A-CORE JIANGMEN ELECTRONICS CO.,LTD  
 江门安磁电子有限公司  
 Tel: 86-750-3867791 Fax : 86-750-3867787

REVISIONS				
REV	SYM	DRAFTER	CHECKER	DATE
①		G.F.YANG	W.H.HSU	03/04/09
②		G.F.YANG	W.H.HSU	05/19/09
③				

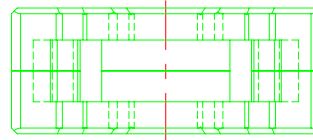
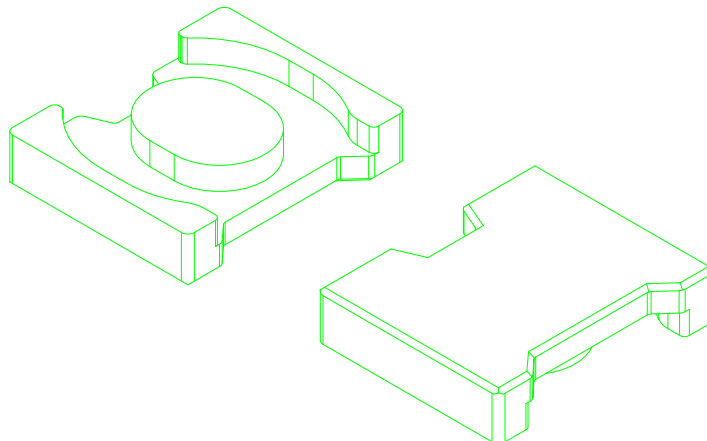
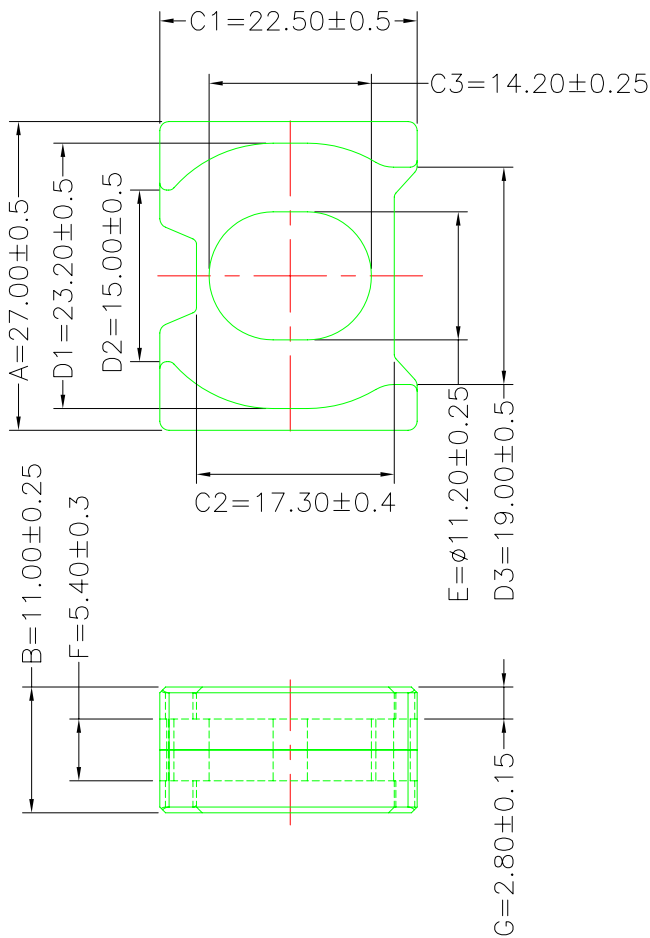

### Core Set Parameters

$A_e = 129 \text{mm}^2$   
 $L_e = 36.4 \text{mm}$   
 $C_1 = 0.282 \text{mm}^{-1}$   
 $V_e = 4695.6 \text{mm}^3$

DWG NO. ATQ27/11-CORE

PART NO. MATERIAL (CORE)

ATQ27/11 JPP-44A

ATQ27/11 JPP-95

NOTE

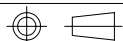

TOLERANCE: .XX±0.25 .XXX±0.127

UNIT : m/m

SCALE 1:1

REV 2

**A-CORE**

A-CORE JIANGMEN ELECTRONICS CO.,LTD  
 江門安磁電子有限公司

**TBI**

TRANSFORMER BOBBIN  
 INDUSTRIAL CO.,LTD.

ELECTRICAL CO. Tel : 86-750-3867791 Fax : 86-750-3867787

Tel : 86-769-88789999 Fax : 86-769-88789989

e-mail : sales@acore-ferrite.com

http:// tbi-tw.com e-mail : tb6688@ms46.hinet.net

REVISIONS

REV	SYM	DRAFTER	CHECKER	DATE
3		G.F.YANG	W.H.HSU	05/15/09
4		G.F.YANG	W.H.HSU	07/27/10
5		F.LU	G.F.YANG	12/24/10

TOP

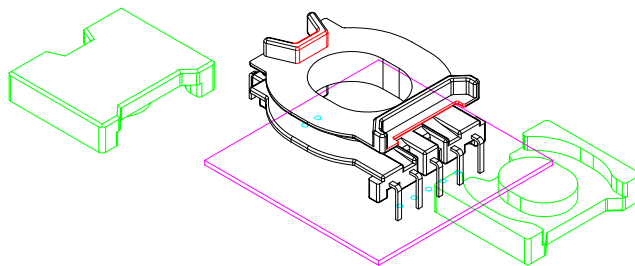
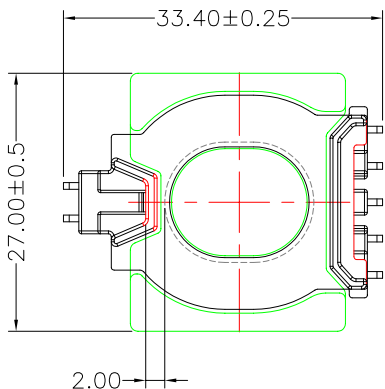

TOP

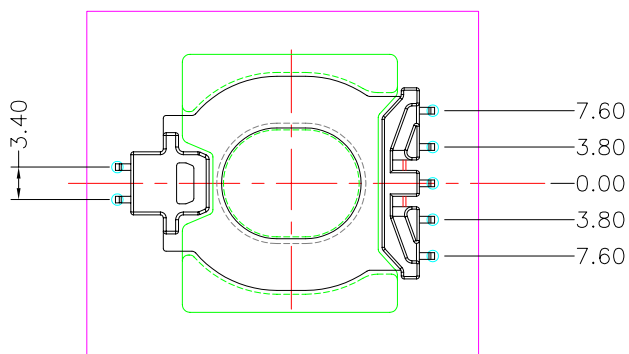
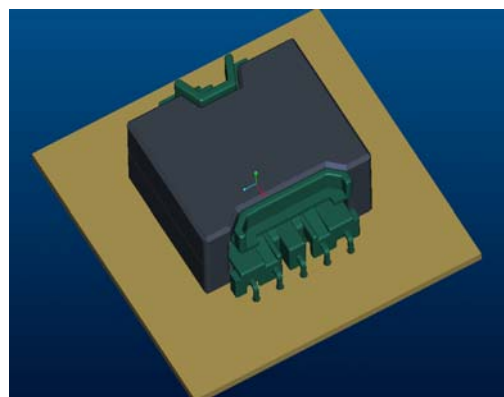
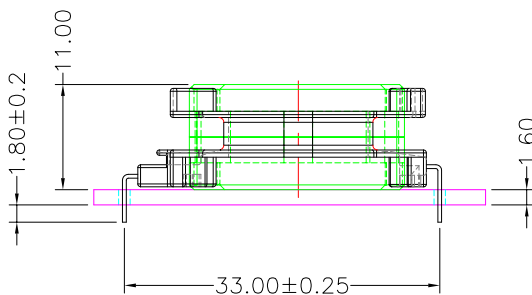
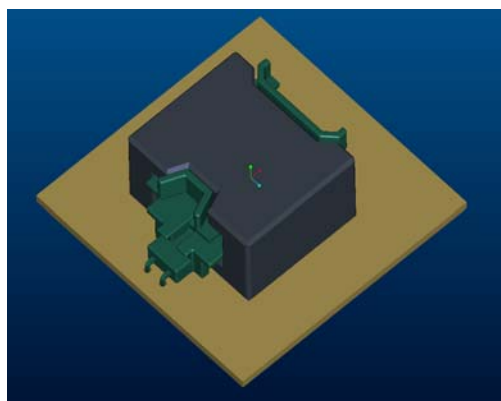

BOTTOM

ITEM	PART NO.	MATERIAL	DWG NO.	Core Set Parameters
CORE	ATQ27/11	JPP-44A		$A_e=129\text{mm}^2$ $L_e=36.4\text{mm}$ $C1=0.282\text{mm}^{-1}$ $V_e=4695.6\text{mm}^3$
CORE	ATQ27/11	JPP-95		
BOBBIN	TBI-238-03081.1106		ATQ27-11-7P-THT-0H-11	

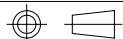

UNIT : m/m

SCALE 1 : 1

REV

5